

SHARP HILLS WIND FARM

Shadow Flicker Map for 297.1 MW Wind Farm

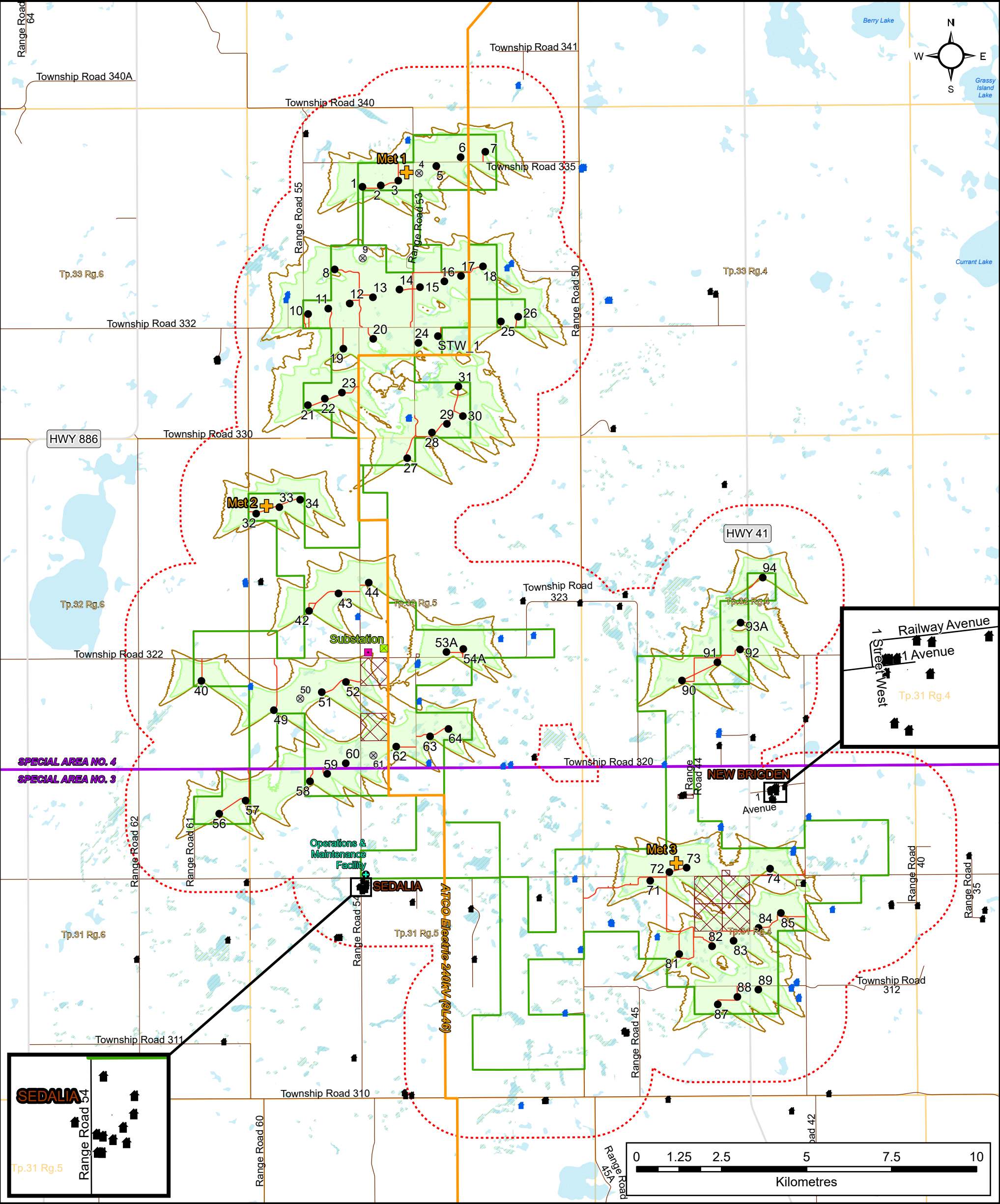

- Legend**
- Approved Turbine Locations (67)
 - ⊗ Removed Turbine
 - ▭ Current Project Boundary
 - ▭ Non-Project Land
 - ⊕ Operations & Maintenance Facility
 - ▭ Approved Laydown Yard Location
 - ▭ Approved Substation Location
 - ⊕ Approved Meteorological Towers
 - 🏠 Participating House
 - 🏠 Non-Participating House

- Shadow Flicker - Adjusted Case**
- ▭ Shadow Flicker (15 hours per year)
 - ▭ Shadow Flicker (8 hours per year)
 - Approved Turbine Access Roads
 - Existing 240kV Transmission Line (Single Circuit)
 - ▭ 2km Notification Zone
 - ▭ Special Areas 3 & 4
 - Numbered Highways
 - Municipal Roads
 - Hydrography
 - ▭ Class 3 - 5 Waterbodies
 - ▭ Township

Author: Solas Energy Consulting Inc.
Date / Time: 15 July 2021
Datum: North American 1983
Projection: NAD 1983 UTM Zone 12N
Scale: 1:110,000
Sources: EDPR, ESRI, AER, Ventyx, AltaLIS, RWDI.

Notes

Turbine labels with "STW" refer to those turbines that were previously "Subject to Waiver" from adjoining non-project landowners. All STW turbines have received and executed these waivers.

The Project boundary is not representative of the entire leased land base.

